

GHS 197 x 5 x 6875 C	Product Code	:43197568753
	Reference No	:04-001

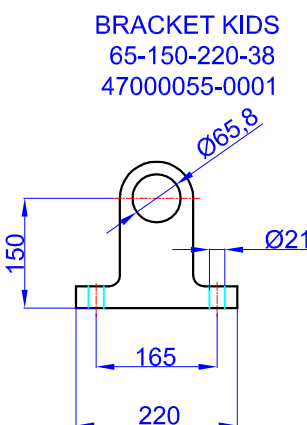
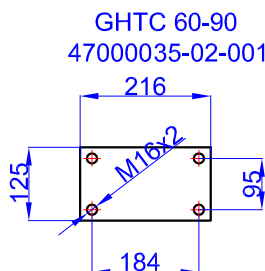
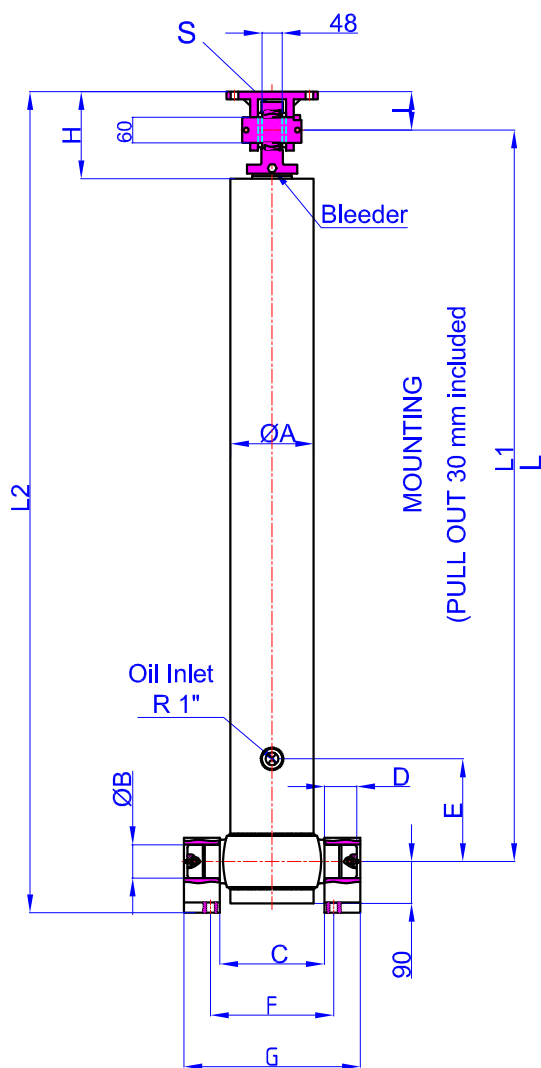

A	:	220	mm
B	:	65	mm
C	:	265	mm
D	:	60	mm
E	:	200	mm
F	:	343	mm
G	:	425	mm
H	:	185	mm
I	:	90	mm
L	:	1670	mm
*L1	:	1700	mm
L2	:	1910	mm
S	:	52	mm

* Inc 30 mm pull out :
tolerance +20 -0

Hard Chromed all stages

Working Pressure : 135 Bar

Max. Working Pressure : 150 Bar

All Cylinder Materials are St 52 Cold Drawn Tubes

Tipping Weight = Weight Body + Payload

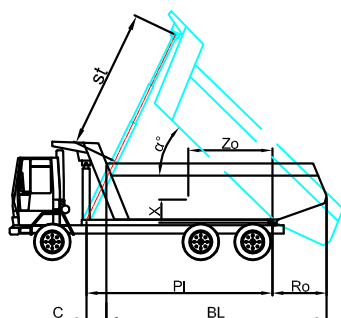

STAGE	1	2	3	4	5	6	7	8	TOTAL
EFFECTIVE DIAMETER (mm)	Ø197	Ø175	Ø154,5	Ø135	Ø116				
STROKE	1375	1375	1375	1375	1375				6875
OIL DISPLACEMENT (L)	44	35	27,5	21	15,5				143
135 BAR (TONS)									60 T

BL (body length)	8800			8600			8400			
Ro (rear overhang)	200	500	800	200	500	800	200	500	800	
α°	45	46	48	46	48	50	47	49	51	
Ycog (vert. pos. centre of gravity)										
PI (Pivot length)	600	49	52	57	50	54	59	51	55	60
	900	52	57	62	53	57	64	55	60	66
	1200	56	61	68	57	63	71	59	65	74
α° = st x 60 / PI	st	6600	6516	6560	6593	6640	6666	6580	6615	6630