

GHS 135 x 3 x 2760 C	Stock Code	: 43135327603
	Reference No	: 02-001

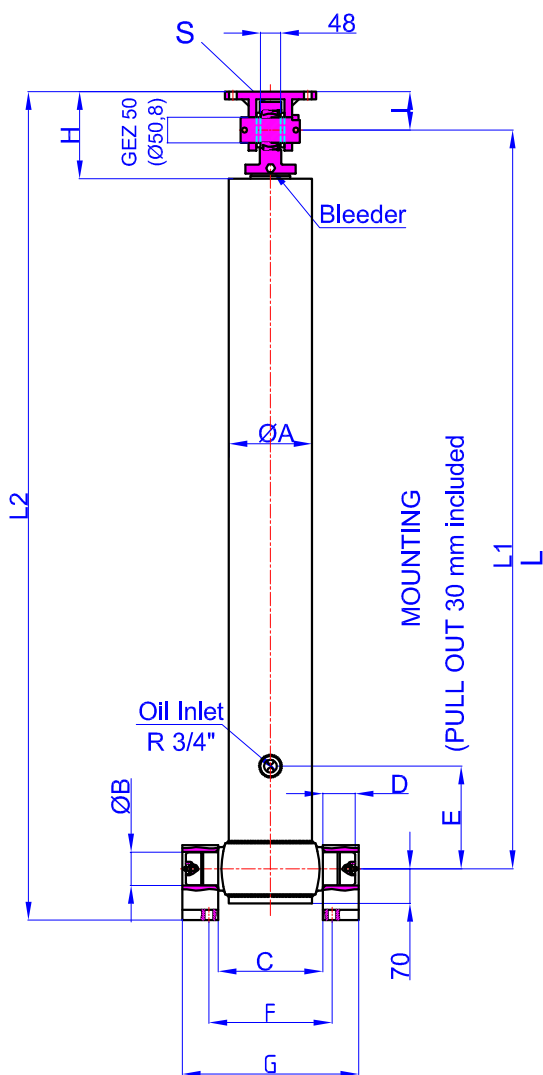

47000028-02-001
 (Bracket Kits Top Clevis
 GHTC GEZ 50x80)

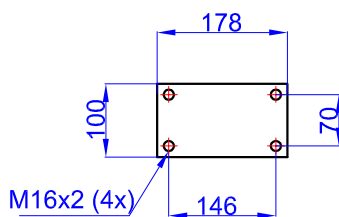

47000057-0001
 (Bracket Kits T
 60-100-150-22)

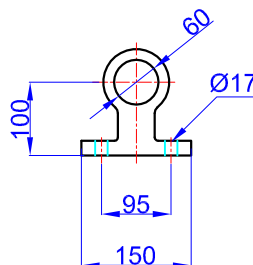

A	:	156	mm
B	:	60	mm
C	:	193	mm
D	:	60	mm
E	:	200	mm
F	:	240	mm
G	:	333	mm
H	:	170	mm
I	:	75	mm
L	:	1168	mm
*L1	:	1198	mm
L2	:	1343	mm
S	:	52	mm

* Inc 30 mm pull out :
 tolerance +20 -0

Hard Chromed all stages
 Working Pressure : 135 Bar
 Max. Working Pressure : 150- Bar
 All Cylinder Materials are St 52 Cold Drawn Tubes
 Tipping Weight = Weight Body + Payload

STAGE	1	2	3	4	5	6	7	8	TOTAL
EFFECTIVE DIAMETER (mm)	Ø135	Ø116	Ø98						
STROKE	920	920	920						2760
OIL DISPLACEMENT (L)	14	10,5	7,5						38
135 BAR (TONS)									24 T

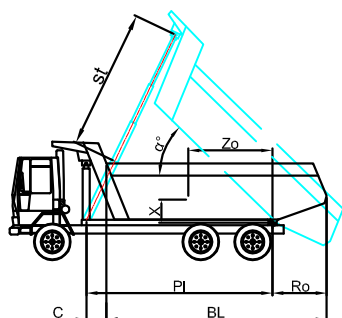

BL (body length)
 Ro (rear overhang)
 Ycog (vert. pos. centre of gravity)
 PI(Pivot length)
 $\alpha^\circ = \text{st} \times 60 / \text{PI}$

	3400	4000	4600	3300	4000	4600	3200	4000	4600
BL	3400	4000	4600	3300	4000	4600	3200	4000	4600
Ro	200	400	600	200	400	600	200	400	600
α°	45	48	52	47	50	54	48	52	56
Ycog	40	49	61	42	52	63	44	55	65
900	49	57	67	51	59	68	52	60	69
1200	53	60	67	55	61	68	56	62	69
st	2550	2560	2600	2585	2583	2610	2560	2600	2613